

RoHS
Compliant

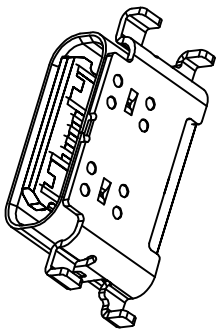

3D VIEW

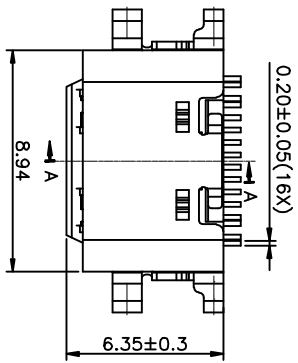
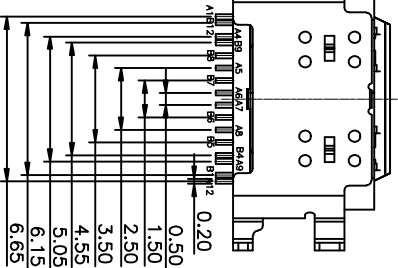
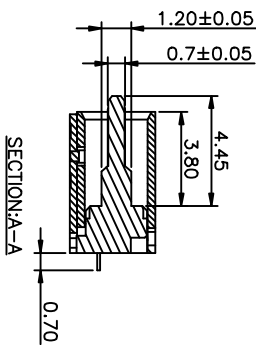
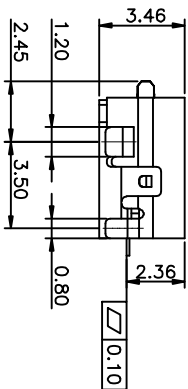
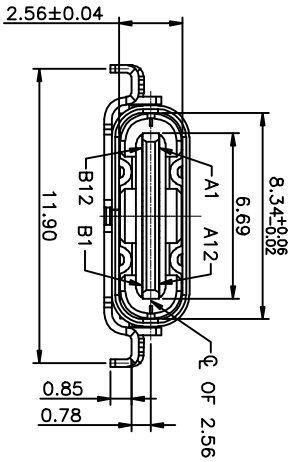

ZONE	ECN. NO.	DESCRIPTION	DRAWING	DATE
A		INITIAL	林生财	2020.02.18

- SPECIFICATIONS:
- ELECTRICAL:
 - CURRENT RATING: 3.0A
 - VOLTAGE RATING: 5.0V
 - VBUS & GND PINS AND OTHER PINS: 40mΩ/PIN MAX. SHIELD: 50mΩ/MAX. ILCR MAX. CHANGE OF ALL PINS: 10mΩ.
 - INSULATION RESISTANCE: 100MΩ MIN
 - DIELECTRIC WITHSTAND VOLTAGE/AC 100V FOR 1 MINUTE.
 - MECHANICAL PERFORMANCE:
 - INSERTION FORCE: 0.5~2.0kgf.
 - REMOVAL FORCE: 0.8kgf~2.0kgf.
 - DURABILITY: 10000 CYCLES.
 - ENVIRONMENTAL PERFORMANCE:
 - OPERATING TEMPERATURE: -25℃~+85℃.
 - AIR REFLOW: THE PEAK TEMPERATURE ON THE BOARD SHALL BE MAINTAINED FOR 10 SECONDS AT 260℃.

NO.	DESCRIPTION	MATERIAL	REMARKS	QTY
1	HOUSING	LCP 94V-0	COLOR BLACK	1
2	CONTACT	COPPER ALLOY	NI 50μ MIN. UNDER PLATED OVER ALL. NI PLATED ON THE FUNCTIONAL AREA OF CONTACT. PLATING SPECIFICATIONS OF THE SOLDER AREA FOLLOW THE P/N	24
3	MID PLATE	STAINLESS STEEL	CLEAN	1
4	FRONT SHELL	STAINLESS STEEL	NI 300μ MIN. UNDER PLATED OVER ALL	1
5	COVER	STAINLESS STEEL	NI 300μ MIN. UNDER PLATED OVER ALL	1

LZG INDUSTRIAL CO. LTD

PART NAME: TYPE C 16 PIN

TOLERANCE UNLESS OTHERWISE SPECIFIED: 0.00±0.05

UNIT: mm

DRAWING NO. ZB48032-16FBAP-A

DATE: 2020.02.18

DWG. NO.

SHEET 1/2

F

E

D

C

B

A

ZONE	ECN. NO.	DESCRIPTION	DRAWING	DATE
A		INITIAL	林生财	2020.02.18

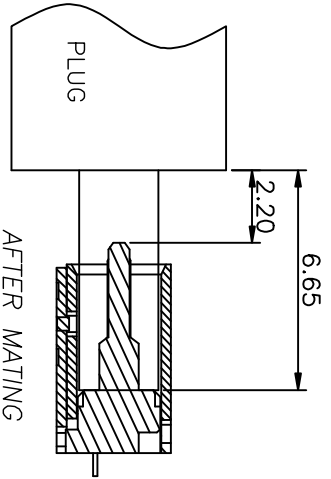

USB TYPE-C PIN ASSIGNMENTS

PIN NUMBER	SIGNAL NAME	PIN NUMBER	SIGNAL NAME
A1	GND	B12	GND
A4	VBUS	B9	VBUS
A5	CC1	B8	SBU2
A6	Dp1	B7	Dn2
A7	Dn1	B6	Dp2
A8	SBU1	B5	CC2
A9	VBUS	B4	VBUS
A12	GND	B1	GND

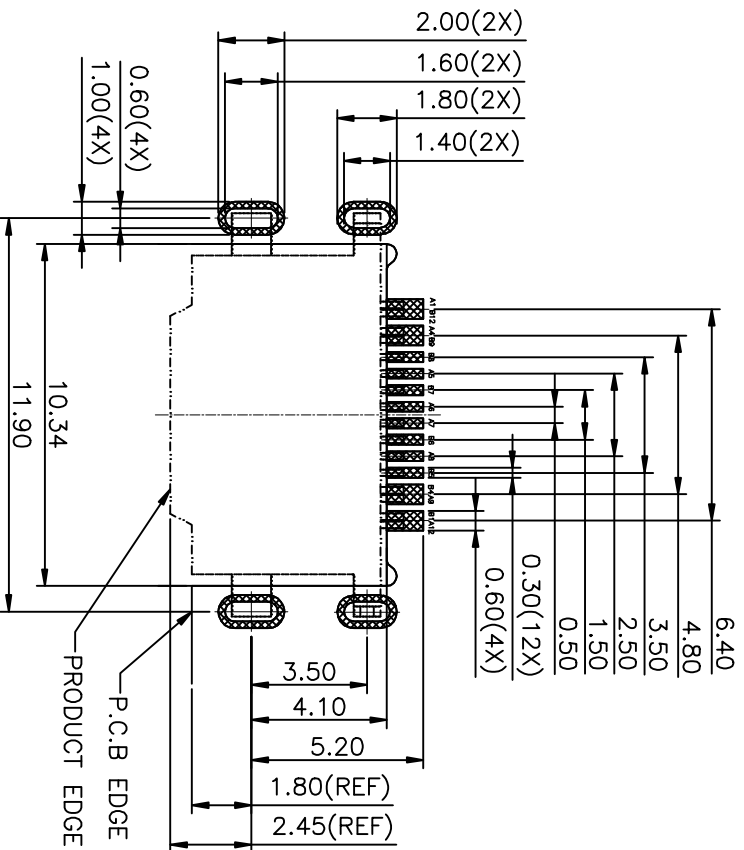

RECOMMENDED PCB LAYOUT(TOP VIEW)
THICKNESS 0.80MM;DEFAULT TOLERANCE:±0.05



LZG INDUSTRIAL CO., LTD

PART NAME	TYPE C 16 PIN	TOLERANCE UNLESS	0.0±0.3	0.1±2°	UNIT:
PART NO.	ZB48032-16FBAP-A	OTHERWISE SPECIFIED:	0.00±0.1	0.0°±1'	mm

DRAWING:	林生财	DATE:	2020.02.18	SCALE	1:1
CHECK:	李宏鑫	DATE:	2020.02.18	MATERIAL	*
APPROVAL:	柳进宝	DATE:	2020.02.18	DWG. NO.	
DRAWING NO.	ZB48032-16FBAP-A	SHEET			2/2

F

E

D

C

B

A

4

3

2

1

4

3

2

1