

Recommended PCB Layout  
Tolerance: ±0.1 (Top view)

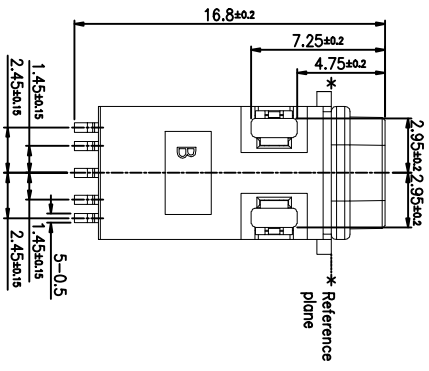

□ : TERMINAL NO.    ○ : ITEM NO.

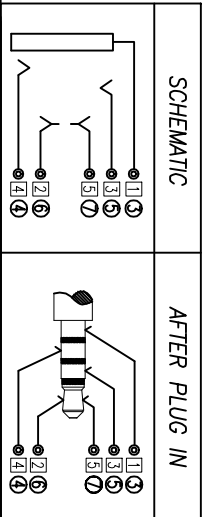

| NO. | DESCRIPTION   | MATERIAL     | REMARKS                                      | QTY |
|-----|---------------|--------------|--|-----|
| 10  | OVIAL RING    | SILICONE     |  | 1   |
| 9   | BOND          | EPOXY        |  | 1   |
| 8   | TERMINAL      | C26890 t=0.2 | Gold flash plating Nickel 40u"min underplate | 2   |
| 7   | TP SPRING-2   | Ti-Cu t=0.2  | Gold flash plating Nickel 40u"min underplate | 1   |
| 6   | TP SPRING-1   | Ti-Cu t=0.2  | Gold flash plating Nickel 40u"min underplate | 1   |
| 5   | RING SPRING-2 | Ti-Cu t=0.2  | Gold flash plating Nickel 40u"min underplate | 1   |
| 4   | RING SPRING-1 | Ti-Cu t=0.2  | Gold flash plating Nickel 40u"min underplate | 1   |
| 3   | EARTH SPRING  | Ti-Cu t=0.2  | Gold flash plating Nickel 40u"min underplate | 1   |
| 2   | COVER         | PA97 94V-0   | COLOR BLACK                                  | 1   |
| 1   | HOUSING       | PA97 94V-0   | COLOR BLACK                                  | 1   |

| ZONE | EC N. NO. | DESCRIPTION | DRAWING | DATE       |
|------|-----------|-------------|---------|------------|
| A    |           | INITIAL     | 林生财     | 2020.02.18 |

- SPECIFICATIONS:
1. RATED VOLTAGE: DC 12V
  2. INSULATION RESISTANCE: A VOLTAGE OF 500V D.C. SHALL BE APPLIED TO THE TERMINALS, AFTER WHICH MEASUREMENT SHALL BE MADE. A GAUGE FOR THE MEASUREMENT SHALL BE USED. THE INSULATED GAUGE.
  3. CONTACT RESISTANCE: 30mΩ OR LESS
  4. VOLTAGE PROOF: 500V AC FOR ONE MINUTE
  5. DURABILITY: 5,000 INSERTION/REMOVAL CYCLES (MINIMUM)
  6. INSERTION FORCE: 0.6KGF~2.0KGF
  7. WITHDRAWAL FORCE: 0.6KGF~2.0KGF
  8. WATER PROOFNESS: This product is based on IPX5/7 of the JIS Standard.
  9. USING PLUG: φ3.5MM, 4-POLE STEREO EARTH/PHONE(LCH/RCH/GND/MIC) PROVIDED THAT THEY CONFORM TO JIS C6560
  10. HOUSING STRENGTH IS 50N MAX

**LZG** INDUSTRIAL CO., LTD

| PART NAME | WATERPROOF Ø3.5 PHONE JACK | TOLERANCE UNLESS OTHERWISE SPECIFIED: | 0.0±0.25  | 0.0±0.2   | 0.1±1.1  | UNIT: | mm | APPROVAL: | DRAWING NO.:     |
|-----------|----------------------------|---------------------------------------|-----------|-----------|----------|-------|----|-----------|------------------|
| PART NO.  | ZB23013-07SBAP-A           |                                       | 0.00±0.20 | 0.00±0.10 | 0.00±0.5 |       |    | 林生财       | ZB23013-07SBAP-A |

| CHECK: | DATE:      | SCALE: |
|--------|------------|--------|
| 李宏鑫    | 2020.02.18 | 1:1    |

| DATE:      | MATERIAL |
|------------|----------|
| 2020.02.18 |          |

| DATE:      | DWG. NO. |
|------------|----------|
| 2020.02.18 |          |

| DATE:      | SHEET |
|------------|-------|
| 2020.02.18 | 1/2   |

|                |  |             |  |         |  |            |  |
|----------------|--|-------------|--|---------|--|------------|--|
| ZONE EC N. NO. |  | DESCRIPTION |  | DRAWING |  | DATE       |  |
| A              |  | INITIAL     |  | 林生财     |  | 2020.02.18 |  |

Oval ring drawing

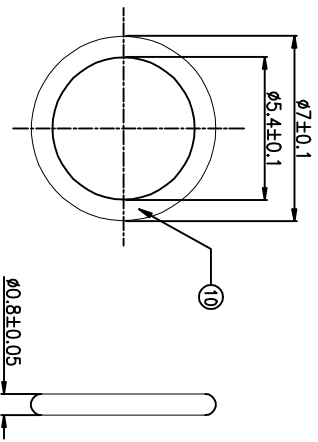

注:防水圈不用组装在产品上,要与产品配套单独出货。  
Note:Waterproof ring need not assembled on the product, to form a complete set of product shipped separately.

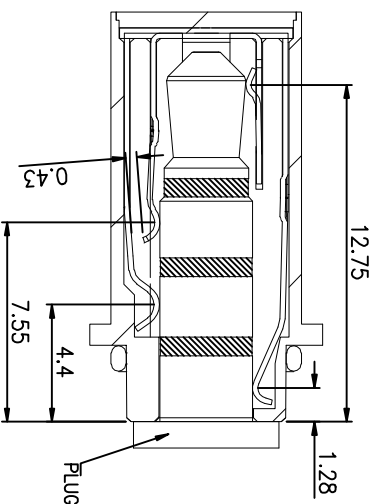

SEC:A-A  
Image of plug match with contact point

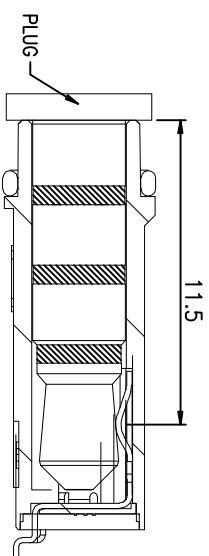

SEC:B-B  
Image of plug match with contact point

**LZG** INDUSTRIAL CO., LTD

|           |                            |                                       |                                     |                                 |       |    |              |                  |       |     |
|-----------|----------------------------|---------------------------------------|-------------------------------------|---------------------------------|-------|----|--------------|------------------|-------|-----|
| PART NAME | WATERPROOF Ø3.5 PHONE JACK | TOLERANCE UNLESS OTHERWISE SPECIFIED: | 0.0H±0.25<br>0.00±0.20<br>0.00±0.10 | 0°.±2°<br>0.0°±1°<br>0.00°±0.5° | UNIT: | mm | DRAWING NO.: | ZB23013-07SBAP-A | SHEET | 2/2 |
| PART NO.  | ZB23013-07SBAP-A           |                                       |                                     |                                 |       |    |              |                  |       |     |

|           |     |       |            |          |     |
|-----------|-----|-------|------------|----------|-----|
| DRAWING:  | 林生财 | DATE: | 2020.02.18 | SCALE    | 1:1 |
| CHECK:    | 李宏鑫 | DATE: | 2020.02.18 | MATERIAL | *   |
| APPROVAL: | 杨进宝 | DATE: | 2020.02.18 | DWG. NO. |     |